

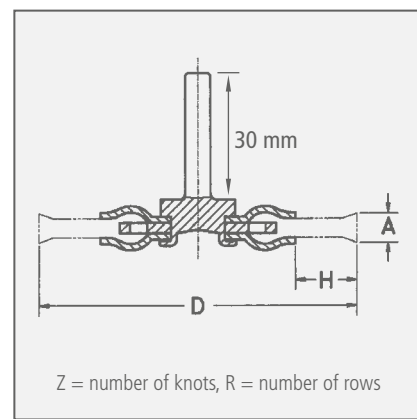

Wheel Brushes with Shank



Wheel Brushes with Shank

The wheel brushes shown on these pages are manufactured with a mounted shank for professional use. Tight filling wire and balanced running make these brushes excellent tools.

Knotted Wheel Brushes with Shank

It does not matter if the brush has one or two rows, the brush is the perfect tool for removing underseal, rust deburring, roughening etc. For working in narrow places we recommend our brush 417.198.11, which is an especially narrow Brush.

Encapsulated Brushes

By embedding in tough plastic the filling width always remains the same and early break of the wires can be prevented. It's the perfect tool for long lasting and safe working. The colour on the picture can differ from the colour on the brush.

Wheel brushes with shank completely stainless steel

All the inner and outer parts of these brushes such as shanks, side plates, rings, etc. are made of stainless steel. Therefore these brushes are the perfect tool for working in damp and difficult places. These brushes do not have green side plates.

Structuring Brushes with Shank

These brushes are special brushes which can be used for wood grain surfaces.

Shank Brushes with Silicon Carbide Bristles

The high quality bristles with silicon carbide can be used for deburring, polishing and structuring of stainless steel, aluminium and plastic surfaces. Besides the articles mentioned on this page we can also supply other grits, diameters and widths.

Item Nos. in bold are available ex stock. Consider our minimum order value for *italic printed* article numbers (see page 139).

STA = steel wire, crimped
STH = steel wire, high tensile, straight
ROH = stainless steel wire, high tensile

Stainless Steel Brushes

LESSMANN brushes with stainless steel wire have green side plates. We use wire with material number 1.4310. Material number 1.4401. can be used on request. More information for brush applications on stainless materials you will find at www.lessmann.com

The brushes have a 6 mm shank. On demand the brushes can also be supplied with 1/4" shanks (USA execution).

Brushes with other diameters, filling widths and filling material are available on request.

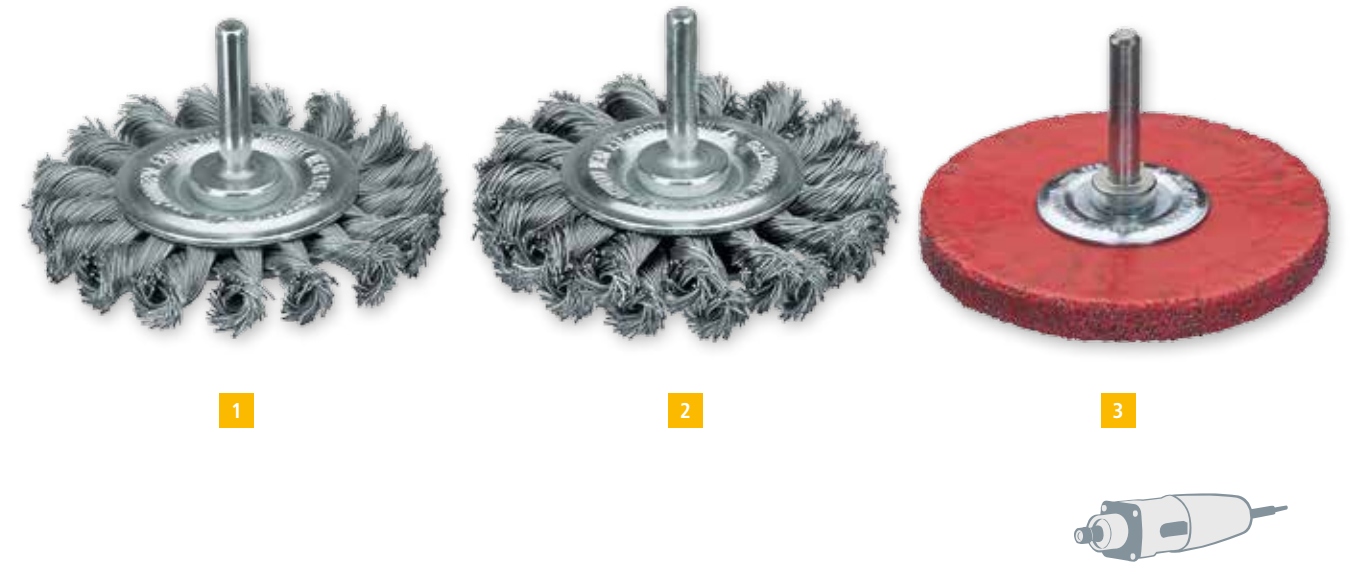

Knotted Wheel Brushes with Shank Ø 6 mm										
	D	A	H	Z	R	RPM	Pack.	STH 0.35 0.014"	STH 0.50 0.020"	ROH 0.50 0.020"
	mm inch	mm inch	mm inch			max.		Art.-No.	Art.-No.	Art.-No.
1	75 3	9 3/8	15 5/8	18	1	25,000	10		417.198.11	
	75 3	12 1/2	15 5/8	18	1	25,000	10	417.168	417.198	417.398
2	75 3	16 5/8	15 5/8	18	2	25,000	10		417.199	417.399

Wheel Brushes with Shank Ø 6 mm, Encapsulated									
	D	A	H		RPM	Pack.	STA 0.30 0.012"		
	mm inch	mm inch	mm inch		max.		Art.-No.		
3	50 2	8 5/16	13 1/2		15,000	10	415.160		
	60 2 3/8	8 5/16	18 3/4		15,000	10	416.160		
	76 3	8 5/16	23 7/8		15,000	10	417.160		

Wheel Brushes with Shank



Wheel Brushes with Shank Ø 6 mm						1 2		3	
D	A	H	RPM	Pack.	STA 0.15 0.006"	STA 0.20 0.008"	STA 0.30 0.012"	STA 0.50 0.020"	STM 0.25 0.010"
mm inch			max.		Art.-No.	Art.-No.	Art.-No.	Art.-No.	Art.-No.
20 3/4	6	3	20,000	10	411.132	411.142			
30 1 1/4	6	6	20,000	10	413.132	413.142	413.162		
30 1 1/4	9	6	20,000	10	<i>413.133</i>	<i>413.143</i>	<i>413.163</i>		
40 1 3/8	8	9	18,000	10	414.132	414.142	414.162	414.192	<i>414.752</i>
40 1 3/8	11	9	18,000	10	<i>414.133</i>	<i>414.143</i>	<i>414.163</i>	<i>414.193</i>	available on demand
50 2	10	12	15,000	10	<i>415.132</i>	<i>415.142</i>	<i>415.162</i>	415.192	415.752
50 2	14	12	15,000	10	415.133	415.143	415.163	<i>415.193</i>	available on demand
60 2 3/8	10	17	15,000	10	<i>416.132</i>	<i>416.142</i>	<i>416.162</i>	available on demand	<i>416.752</i>
60 2 3/8	14	17	15,000	10	416.133	416.143	416.163	<i>416.193</i>	available on demand
70 2 3/4	12	19	15,000	10	<i>417.132</i>	<i>417.142</i>	<i>417.162</i>	417.192	417.752
70 2 3/4	16	19	15,000	10	417.133	417.143	417.163	available on demand	available on demand
80 3 1/4	12	20	15,000	10	available on demand	418.142	418.162	<i>418.192</i>	<i>418.752</i>
80 3 1/4	18	20	15,000	10	available on demand	418.143	418.163	available on demand	available on demand
70 2 3/4	10	14	15,000	10				417.196*	

Structuring Brushes with Shank Ø 8 mm						4	
D	A	H	RPM	Pack.	STM 0.25 0.010"	SIC 80/1.4	
mm inch			max.		Art.-No.	Art.-No.	
80 3 1/4	35	28	4,000	1	418.704	<i>418.803</i>	

* cambered plates

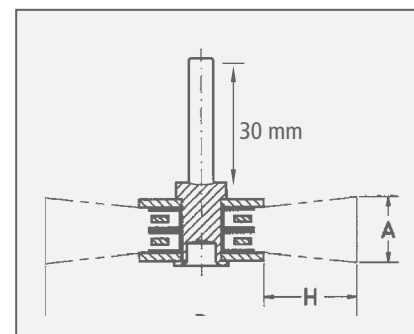

Item Nos. in bold are available ex stock. Consider our minimum order value for *italic printed* article numbers (see page 139).

- STA = steel wire, crimped
- STM = brass coated steel, crimped
- ROF = stainless steel wire, crimped
- MES = brass wire, crimped
- SIC = silicon carbide bristles

Wheel Brushes with Shank Ø 6 mm, Stainless Steel and Brass Wire						1		2	
D	A	H	RPM	Pack.	ROF 0.20 0.008"	ROF 0.30 0.012"	MES 0.20 0.008"		
mm inch	mm inch	mm inch	max.		Art.-No.	Art.-No.	Art.-No.		
20 3/4	6 1/4	3 1/8	20,000	10	411.342		411.542		
30 1 1/4	6 1/4	6 1/4	20,000	10	413.342	<i>413.362</i>	413.542		
30 1 1/4	9 3/8	6 1/4	20,000	10	413.343	<i>413.363</i>	<i>413.543</i>		
40 1 3/8	8 5/16	9 3/8	18,000	10	414.342	414.362	414.542		
40 1 3/8	11 4/9	9 3/8	18,000	10	414.343	available on demand	<i>414.543</i>		
50 2	10 3/8	12 1/2	15,000	10	415.342	415.362	415.542		
50 2	14 9/16	12 1/2	15,000	10	415.343	415.363	415.543		
60 2 3/8	10 3/8	17 5/8	15,000	10	416.342	416.362	416.542		
60 2 3/8	14 9/16	17 5/8	15,000	10	416.343	416.363	416.543		
70 2 3/4	12 1/2	19 3/4	15,000	10	417.342	417.362	417.542		
70 2 3/4	16 5/8	19 3/4	15,000	10	417.343	417.363	417.543		
80 3 1/4	12 1/2	20 3/4	15,000	10	418.342	418.362	418.542		
80 3 1/4	18 3/4	20 3/4	15,000	10	418.343	418.363	418.543		

3 Wheel Brushes with Shank Ø 6 mm, Completely Stainless						ROF 0.20 0.008"		ROF 0.30 0.012"	
D	A	H	RPM	Pack.		Art.-No.	Art.-No.		
mm inch	mm inch	mm inch	max.						
50 2	15 5/8	12 1/2	15,000	10		415.301	415.302		
60 2 3/8	17 5/8	17 5/8	15,000	10		416.303	<i>416.302</i>		
70 2 3/4	18 3/4	19 3/4	15,000	10		417.306	417.309		

4 Wheel Brushes with Shank Ø 6 mm, Silicon Carbide Bristles						SIC 120/0.6		SIC 120/1.1		SIC 180/1.0		SIC 320/0.6	
D	A	H	RPM	Pack.	SIC 120/0.6	SIC 120/1.1	SIC 180/1.0	SIC 320/0.6					
mm inch	mm inch	mm inch	max.		Art.-No.	Art.-No.	Art.-No.	Art.-No.					
30 1 1/4	6 1/4	6 1/4	18,000	10	413.841			413.871					
50 2	10 3/8	12 1/2	15,000	10		415.842	<i>415.852</i>	415.872					
70 2 3/4	12 1/2	20 3/4	15,000	10		417.842	417.852	417.872					
80 3 1/4	14 9/16	22 7/8	15,000	10		418.842	available on demand	418.872					

Cup Shank Brushes



Cup Brushes with Shank

Ideal for working on medium and large areas.

Cup Shank Brushes with Plastic Cup

Cup Shank Brushes with Plastic Cup and stainless steel wire especially are used for applications on stainless steel materials.

The plastic cup prevents contact with the working piece, therefore it protects from corrosion or other foreign particles.

Brushes with steel and stainless steel wire can be used at higher RPM and can therefore be used on electrical and air driven grinding machines. These models are known for their high density of filling material and therefore they have a very long lifetime.

The brushes with silicon carbide bristles can be used for deburring, polishing or structuring of stainless steel, aluminium and plastic surfaces.

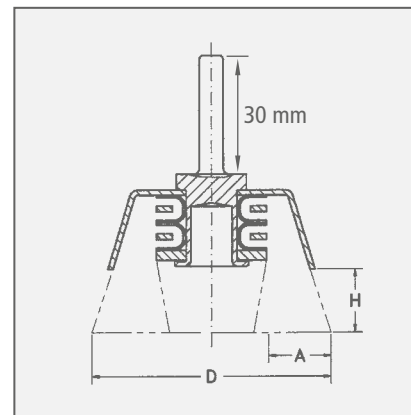

Item Nos. in bold are available ex stock. Consider our minimum order value for *italic printed* article numbers (see page 139).

STA = steel wire, crimped

STH = steel wire, high tensile, straight

ROF = stainless steel wire, crimped

MES = brass wire, crimped

SIC = silicon carbide bristles



Cup Brushes with Shank Ø 6 mm									
D	A	H	RPM	Pack.	1			2	
					STA 0.20 0.008"	STA 0.30 0.012"	ROF 0.20 0.008"	ROF 0.30 0.012"	MES 0.20 0.008"
mm inch	mm inch	mm inch	max.		Art.-No.	Art.-No.	Art.-No.	Art.-No.	Art.-No.
40 1 3/8	15 5/8	20 3/4	10,500	10	434.142	434.162	434.342	434.362	434.542
50 2	22 7/8	20 3/4	10,500	10	435.142	435.162	435.342	435.362	435.542 435.562
60 2 3/8	25 1	25 1	8,000	10	available on demand	436.162	available on demand	436.362	available on demand
70 2 3/4	30 1 1/4	25 1	6,000	10	437.142	437.162	437.342	437.362	437.542

3 Cup Brushes with Shank Ø 6 mm and Plastic Cup							
D	A	H	RPM	Pack.			
					ROF 0.20 0.008"	ROF 0.25 0.010"	ROF 0.30 0.012"
mm inch	mm inch	mm inch	max.		Art.-No.	Art.-No.	Art.-No.
40 1 3/8	20 3/4	30 1 1/4	15,000	10	434.345	434.355	434.365
50 2	25 1	28 1	10,500	10	435.345	435.355	435.365

4 Cup Brushes with Shank Ø 6 mm, Silicon Carbide Bristles						
D	A	H	RPM	Pack.		
					SIC 80/1.2	SIC 320/0.6
mm inch	mm inch	mm inch	max.		Art.-No.	Art.-No.
50 2	10 3/8	20 3/4	4,500	10	430.128	430.129
75 3	15 5/8	22 7/8	4,500	10	430.138	430.139

5 Knot End Brushes with Shank Ø 6 mm, Steel Wire						
D	H	Z	RPM	Pack.		
					STH 0.50 0.020"	
mm inch	mm inch	mm inch	max.		Art.-No.	
75 3	20 3/4	18 3/4	4,500	10		483.230

End Brushes

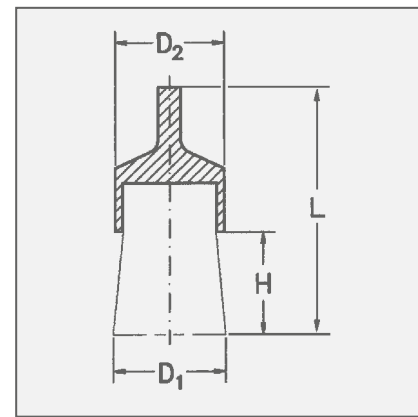

Item Nos. in bold are available ex stock. Consider our minimum order value for *italic printed* article numbers (see page 139).

STA = steel wire, crimped

STH = steel wire, high tensile, straight

ROF = stainless steel wire, crimped

End Brushes with Shank

For cleaning and deburring in hard to reach areas, removal of paint, rubber excess, cleaning of moulds and castings. Also for working on edges and curves, and in the inside of the bores, etc. End brushes are also available in other shapes, spreaded or pointed.

These brushes are perfect for fast moving tools. On demand also with 1/4" shank available.

Special End Brushes, crimping

The special end brushes with narrow crimped wire are characterized by its dense filling. These brushes show a harder brushing effect than brushes with normal crimped wire (e.g. page 70). These brushes are also available with extra long shanks or different diameters.

Square End Brushes

This special tool enables e. g. cleaning of blind holes and processing of bottom and side surfaces in one step.

It's perfect for cleaning and easy deburring applications, e. g. square bores. Other diameters available on demand.

Encapsulated Brushes

By embedding in tough plastic the filling width always remains the same and early break of the wires can be prevented. It's the perfect tool for long lasting and safe working. The advantages when working with encapsulated brushes are longer lifetime and harder brush effect. However, it might be possible that the brush will leave marks on the work piece.

Stainless Steel Brushes

Further information for brushing on stainless steel you will find on www.lessmann.com

Special Design

For your order please state your requirements regarding the measures and wires.

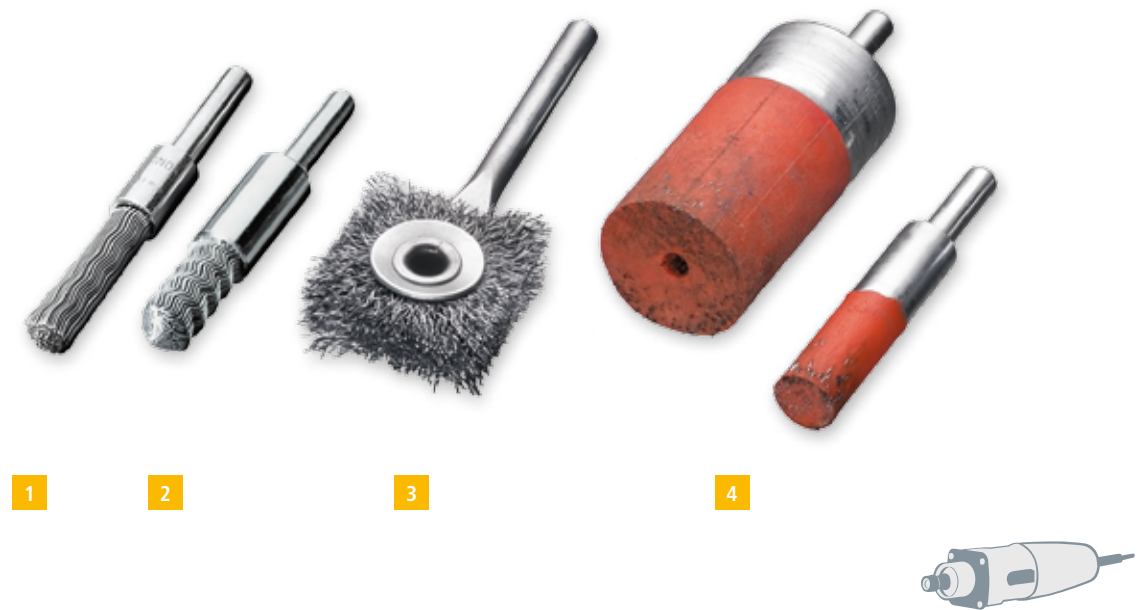

Special End Brushes with Shank Ø 6 mm, narrow crimping

	D1 mm inch	D2 mm inch	H mm inch	L mm inch	RPM max.	Pack.	STA 0.35 0.014"	STH 0.50 0.020"
							Art.-No.	Art.-No.
1	11 4/9	12 1/2	25 1	71 2 3/4	12,000	10	466.171	available on demand
2	11 4/9	12 1/2	25 1	71 2 3/4	12,000	10	466.172*	available on demand*
1	19 3/4	22 7/8	29 1 1/8	72 2 3/4	12,000	10	460.121	available on demand
2	19 3/4	22 7/8	29 1 1/8	72 2 3/4	12,000	10	460.122*	available on demand*

3 Square End Brushes with Shank Ø 6 mm

D1 mm inch	A mm inch	L mm inch	RPM max.	Pack.	STA 0.15 0.006"	STA 0.25 0.010"	ROF 0.30 0.012"
					Art.-No.	Art.-No.	Art.-No.
25.4 1	8 5/16	100 4	4,500	10	469.131	469.151	469.362
31.8 1 1/4	8 5/16	100 4	4,500	10	469.133	469.153	available on demand
38.1 1 1/2	8 5/16	100 4	4,500	10	available on demand	available on demand	available on demand
50.8 2	8 5/16	100 4	4,500	10	available on demand	available on demand	available on demand

4 End Brushes with Shank Ø 6 mm, Encapsulated

D1 mm inch	D2 mm inch	H mm inch	L mm inch	RPM max.	Pack.	STA 0.30 0.012"
						Art.-No.
10 3/8	10 3/8	20 3/4	65 2 1/2	15,000	10	451.160
16 5/8	16 5/8	25 1	72 2 7/8	15,000	10	452.160
22 7/8	22 7/8	25 1	72 2 7/8	15,000	10	453.160
28 1	28 1	30 1 1/4	75 3	10,000	10	456.160

* pointed

BRUSHES WITH SHANK

End Brushes



End Brushes with Shank Ø 6 mm, Steel Wire

	D1	D2	H	L	RPM	Pack.	STA 0.15 0.006"	STA 0.20 0.008"	STA 0.30 0.012"	STA 0.50 0.020"
	mm inch	mm inch	mm inch	mm inch	max.		Art.-No.	Art.-No.	Art.-No.	Art.-No.
1	12 1/2	10 3/8	20 3/4	60 2 3/8	20,000	10	451.131	451.141	451.161	451.191
2	12 1/2	10 3/8	20 3/4	60 2 3/8	20,000	10			451.162*	451.192*
3	12 1/2	10 3/8	20 3/4	120 4 3/4	15,000	10	458.131	458.141	458.161	458.191
4	17 5/8	16 5/8	22 7/8	65 2 1/2	20,000	10	452.131	452.141	452.161	452.191
5	23 7/8	22 7/8	25 1	68 2 3/4	18,000	10	453.131	453.141	453.161	453.191
	30 1 1/4	29 1 1/8	25 1	68 2 3/4	18,000	10	456.131	456.141	456.161	456.191
	50 2	22 7/8	18 3/4	68 2 3/4	18,000	10			453.163**	
6	70 2 3/4	29 1 1/8	25 1	68 2 3/4	18,000	10			456.163**	

9 End Brushes with Shank Ø 6 mm, Steel Wire high tensile, dense version

	D1	D2	H	L	RPM	Pack.	STH 0.30 0.012"
	mm inch	mm inch	mm inch	mm inch	max.		Art.-No.
	12 1/2	12 1/2	20 3/4	66 2 1/2	20,000	10	451.261.BD
	17 5/8	16 5/8	22 7/8	65 2 1/2	20,000	10	452.261.BD
	23 7/8	22 7/8	25 1	68 2 3/4	18,000	10	453.261.BD
	30 1 1/4	29 1 1/8	25 1	68 2 3/4	18,000	10	456.261.BD

End Brushes with Shank Ø 6 mm, Brass Steel Wire, Cord Wire

	D1	D2	H	L	RPM	Pack.	STM 0.25 0.010"	STL 0.175 0.007"	STL 0.22 0.009"
	mm inch	mm inch	mm inch	mm inch	max.		Art.-No.	Art.-No.	Art.-No.
	17 5/8	16 5/8	22 7/8	65 2 1/2	20,000	10	452.751	452.703	452.705
	23 7/8	22 7/8	25 1	68 2 3/4	18,000	10	453.751	453.703	453.705
	30 1 1/4	29 1 1/8	25 1	68 2 3/4	18,000	10	456.751	456.703	456.705

* pointed | ** spreaded



End Brushes with Shank Ø 6 mm, Stainless Steel and Brass Wire

	D1	D2	H	L	RPM	Pack.	ROF 0.20 0.008"	ROF 0.30 0.012"	MES 0.20 0.008"	MES 0.30 0.012"
	mm inch	mm inch	mm inch	mm inch	max.		Art.-No.	Art.-No.	Art.-No.	Art.-No.
	12 1/2	10 3/8	20	60	20,000	10	451.341	451.361	451.541	451.561
	12 1/2	10 3/8	20	60	20,000	10		451.362*	available on demand	available on demand
3	12 1/2	10 3/8	20	120	15,000	10	458.341	458.361	458.541	458.561
	17 5/8	16 5/8	22	65	20,000	10	452.341	452.361	452.541	452.561
	23 7/8	22 7/8	25	68	18,000	10	453.341	453.361	453.541	453.561
	30 1 1/4	29 1 1/8	25	68	18,000	10	456.341	456.361	456.541	456.561
	50 2	22 7/8	18	68	18,000	10		453.363**		

4 End Brushes with Shank Ø 6 mm, Silicon Carbide Bristles

	D1	D2	H	L	RPM	Pack.	SIC 120/1.1	SIC 180/1.0	SIC 320/0.6
	mm inch	mm inch	mm inch	mm inch	max.		Art.-No.	Art.-No.	Art.-No.
	12 1/2	10 3/8	20 3/4	60 2 3/8	20,000	10	451.831	451.851	451.871
	17 5/8	16 5/8	22 7/8	68 2 3/4	20,000	10	452.831	452.851	available on demand
	23 7/8	22 7/8	25 1	70 2 3/4	10,000	10	454.831	454.851	454.871
	30 1 1/4	28 1	30 1 1/4	75 3	10,000	10	456.831	456.851	456.871

* pointed | ** spreaded

Brushes also available with plastic cover.

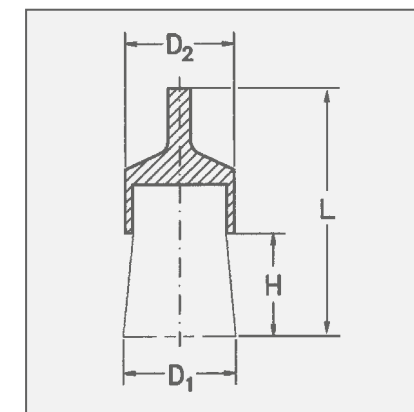

Item Nos. in bold are available ex stock. Consider our minimum order value for italic printed article numbers (see page 139).

- STA = steel wire, crimped
- STH = steel wire, high tensile, crimped
- STM = brass coated steel, crimped
- STL = cord wire, crimped
- ROF = stainless steel wire, crimped
- MES = brass wire, crimped
- SIC = silicon carbide bristles

Knot End Brushes



BRUSHES WITH SHANK

Opening of the end brushes depending on the RPM

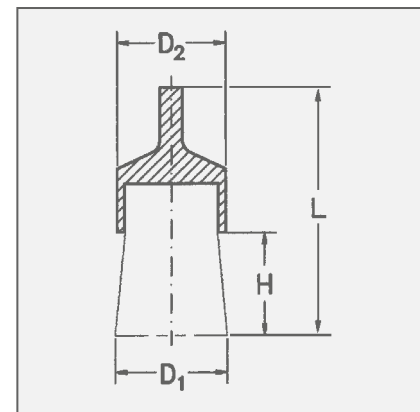
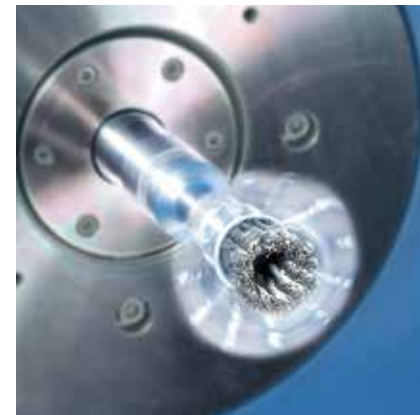
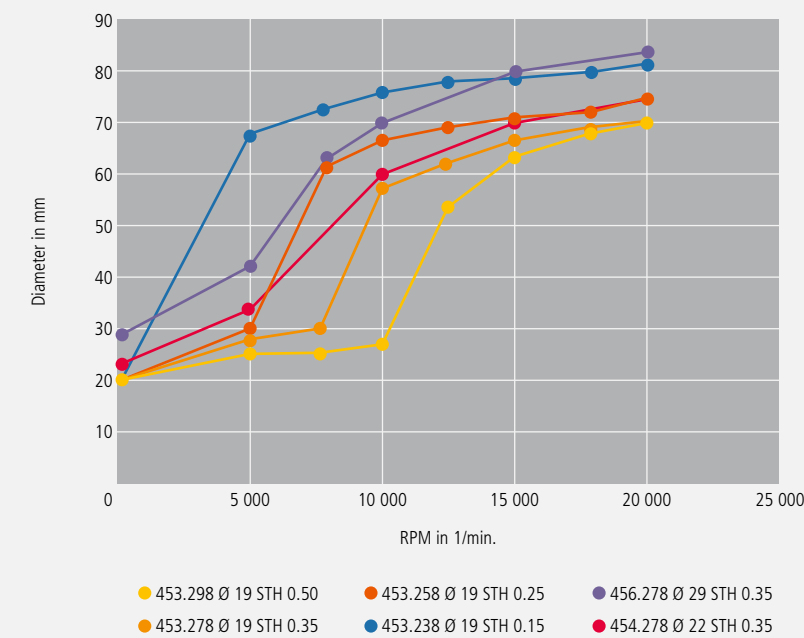

Knotted End Brushes with Shank

According to the RPM the brush will vary in dimension and enable the user to work in hard to reach areas such as drilled holes and recesses of all kinds.

The cups of the knot end brushes with stainless steel wire are coated with plastic to protect the stainless surface. Knotted end brushes with stainless steel wire are green characterized.

Further information on working on stainless steel you find at www.lessmann.com

Special End Brushes with Shank 6 Ø, one Knot

One-knotted End Brushes to render precise working possible.

End Brushes, filled with epoxy resin

End Brushes filled with epoxy resin are able to treat small, defined areas. The brushes are more aggressive and allow a precise handling, hence they are used e.g. for electrical cabinets or for treating mounting surfaces.

Item Nos. in bold are available ex stock. Consider our minimum order value for *italic printed* article numbers (see page 139).

STH = steel wire, high tensile, straight
 STM = brass coated steel, crimped
 RO4 = stainless steel wire, straight, 1.4401

Knotted End Brushes with Shank Ø 6 mm, Steel Wire

	D1/D2 mm inch	L mm inch	H mm inch	Z	RPM max.	Pack.	STH 0.15 0.006" Art.-No.	STH 0.25 0.010" Art.-No.	STH 0.35 0.014" Art.-No.	STH 0.50 0.020" Art.-No.
1	6/10 1/4/3/8	65 2 1/2	25 1	1	4,500	10	available on demand	451.258	451.278	available on demand
2	19 3/4	72 2 7/8	28 1	6	20,000	10		453.258	453.278	453.298
3	22 7/8	72 2 7/8	28 1	8	20,000	10	454.238	454.258	454.278	454.298
4	29 1 1/8	72 2 7/8	28 1	12	20,000	10	available on demand	456.258	456.278	456.298
5	19 3/4	72 2 7/8	28 1	4	20,000	50	available on demand	available on demand	452.278GH*	available on demand

6 Knotted End Brushes with Shank Ø 6 mm, without Rose Bud, Brass Wire

	D1/D2 mm inch	L mm inch	H mm inch	Z	RPM max.	Pack.	STM 0.25 0.010" Art.-No.
	19 3/4	72 2 7/8	28 1	6	20,000	10	453.758
	22 7/8	72 2 7/8	28 1	8	20,000	10	454.758
	29 1 1/8	72 2 7/8	28 1	12	20,000	10	456.758

7 Knotted End Brushes with Shank Ø 6 mm, Stainless Steel Wire

	D1/D2 mm inch	L mm inch	H mm inch	Z	RPM max.	Pack.	RO4 0.15 0.006" Art.-No.	RO4 0.25 0.010" Art.-No.	RO4 0.35 0.014" Art.-No.	RO4 0.50 0.020" Art.-No.
	6/10 1/4/3/8	65 2 1/2	25 1	1	4,500	10	available on demand	451.458	451.478	available on demand
	19 3/4	72 2 7/8	28 1	6	20,000	10	453.338	453.358	453.378	available on demand
	22 7/8	72 2 7/8	28 1	8	20,000	10	454.338	454.358	454.378	454.398
	29 1 1/8	72 2 7/8	28 1	12	20,000	10	456.338	456.358	456.378	456.398

* filled with epoxy resin

Miniature Brushes



Miniature Brushes

Miniature Brushes are used for polishing, cleaning, or deburring of small-area surfaces or small working pieces. Miniature brushes remove waste and scale from weld seams or soldering points. The brushes are used on metal surfaces, steel, aluminum, cast iron, plastics, stone or wood.

Typical fields of applications:

- Precision tools
- Fine mechanics
- Pneumatic and hydraulics
- Electronics parts, e.g. plates

Miniature Brushes are available in different types as wheel, cup and end brushes.

The typical filling materials are steel wire, stainless steel wire, brass wire or abrasive bristles.

Stainless Steel Brushes

Information on working on stainless steel you find at www.lessmann.com

Please Note: Brushes with bristles or goat hair achieve an ideal brushing result by using polish.



Item Nos. in bold are available ex stock. Consider our minimum order value for *italic printed* article numbers (see page 139).

STH = steel wire, high tensile, straight

ROF = stainless steel wire, crimped

MES = brass wire, crimped

PA = polyamide

SIC = silicon carbide bristles

AO = aluminium oxide bristles

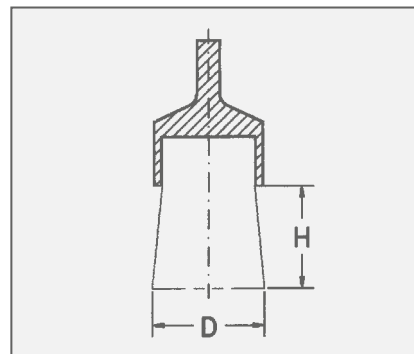
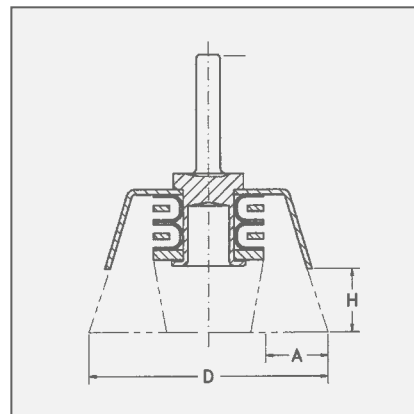
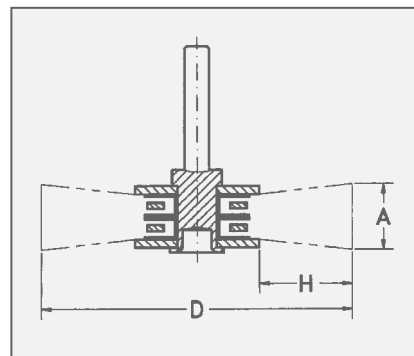

1 Miniature Wheel Brushes with shank Ø 3 mm

D	A	H	RPM	Pack.	STH 0.10	ROF 0.10	MES 0.10	SIC 320/0.55	SIC 500/0.46	SIC 800/0.25	AO 320/0.50
mm	inch		max.		Art.-No.	Art.-No.	Art.-No.	Art.-No.	Art.-No.	Art.-No.	Art.-No.
16	5/8	2	3	15,000	410.221	410.321	410.521	410.871	410.881	410.891	410.871.AO
19	3/4	2	5	12,000	410.222	410.322	410.522	410.872	410.882	410.892	410.872.AO
22	7/8	2	6	10,000	410.223	410.323	410.523	410.873	410.883	410.893	410.873.AO

D	A	H	RPM	Pack.	AO 500/0.46	AO 600/0.30	Diamond K400	PA 0.15	Bristle white	Bristle schwarz	Goat hair
mm	inch		max.		Art.-No.	Art.-No.	Art.-No.	Art.-No.	Art.-No.	Art.-No.	Art.-No.
16	5/8	2	3	15,000	410.801	410.891.AO	410.811.DB	410.031	410.001.WB	410.001.SB	410.001.ZH
19	3/4	2	5	12,000	410.802	410.892.AO	410.812.DB	410.032	410.002.WB	410.002.SB	410.002.ZH
22	7/8	2	6	10,000	410.803	410.893.AO	410.813.DB	410.033	410.003.WB	410.003.SB	410.003.ZH

2 Miniature Cup Brushes with shank Ø 3 mm

D	A	H	RPM	Pack.	STH 0.10	ROF 0.10	MES 0.10	SIC 320/0.55	SIC 500/0.46	SIC 800/0.25	AO 320/0.50
mm	inch		max.		Art.-No.	Art.-No.	Art.-No.	Art.-No.	Art.-No.	Art.-No.	Art.-No.
15	5/8	2	5	15,000	430.222	430.322	430.522	430.872	430.882	430.092	430.872.AO
18	3/4	2	6	15,000	430.223	430.323	430.523	430.873	430.883	430.893	430.873.AO

D	A	H	RPM	Pack.	AO 500/0.46	AO 600/0.30	Diamond K400	PA 0.15	Bristle white	Bristle schwarz	Goat hair
mm	inch		max.		Art.-No.	Art.-No.	Art.-No.	Art.-No.	Art.-No.	Art.-No.	Art.-No.
15	5/8	2	5	15,000	430.802	430.892.AO	430.812.DB	430.031	430.001.WB	430.001.SB	430.001.ZH
18	3/4	2	6	15,000	430.803	430.893.AO	430.813.DB	430.032	430.002.WB	430.002.SB	430.002.ZH

3 Miniature End Brushes with shank Ø 3 mm

D	H	RPM	Pack.	STH 0.10	ROF 0.10	MES 0.10	SIC 320/0.55	SIC 500/0.46	SIC 800/0.25	AO 320/0.50
mm	inch	max.		Art.-No.	Art.-No.	Art.-No.	Art.-No.	Art.-No.	Art.-No.	Art.-No.
5	13/64	8	15,000	450.221	450.311	450.521	450.871	450.881	450.891	450.871.AO

D	H	RPM	Pack.	AO 500/0.46	AO 600/0.30	Diamond K400	PA 0.15	Bristle white	Bristle schwarz	Goat hair
mm	inch	max.		Art.-No.	Art.-No.	Art.-No.	Art.-No.	Art.-No.	Art.-No.	Art.-No.
5	13/64	8	15,000	450.801	450.891.AO	450.821.DB	450.031	450.001.WB	450.001.SB	450.001.ZH

All Brushes also available with shank Ø 2,34 and 3,17 mm.