



Cup Brushes



Cup Brushes

Knot cup brushes are for heavy duty use: for the preparing of metal surfaces before painting, the removal of slag, rust, scale or concrete waste.

The brushes diameter 80/100/125 mm (Art. No. 484/486/487) have a **bridle** fitted for stability. The bridle can be removed after wear of the wire exposing a further 20 mm of useable wire!

We recommend the use of our brush with diameter 90 mm for small angle grinders. Compared to the common brush with diameter 65 mm this model has 50% more wire and it is really something special in the brush market!

Knot Cup Brushes with extra long filling

For the use on large areas and for a flexible cleaning and derusting of e.g. shipyards. For a use in angle grinders. Easy working also in areas which are hard to reach.

Cup Brushes, left-right knotted

Left-right knotted cup brushes usually are more aggressive, hence they are often used for heavy brushing operations.

Besides the knots open less, therefore they are ideal for the treatment of edges.

Cup Brushes

Cup brushes with crimped wire are ideal for working on large surfaces with angle grinders. They can also be used for the removal of rust, paint, dirt or scale and for polishing.

Special Designs

The cup brushes can be delivered with different filling materials according to your requirements e.g. brushes with brass cups and brass wire for non-sparking applications.

For promoting sales all standard wheel brushes are packed individually for self display. They are also available in bulk.

Stainless Steel Brushes

LESSMANN brushes with stainless steel wire have green cups. More information for brush applications on stainless materials you will find at www.lessmann.com

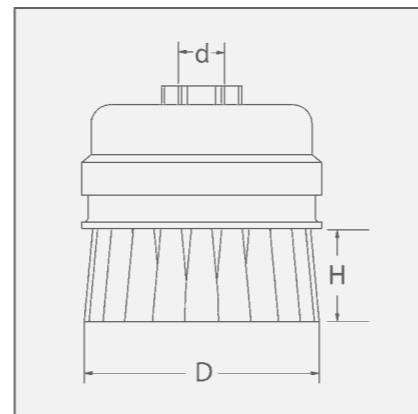

Item Nos. in bold are available ex stock. Consider our minimum order value for *italic printed* article numbers (see page 139).

STH = steel wire, high tensile, straight

STM = brass coated steel, straight

Chunky packaging

Many articles you receive as standard in handy covering boxes (10 pieces per carton).



1 Knot Cup Brushes without Bridle, 1 Row, Steel Wire, Brass coated Steel Wire

D mm inch	d mm inch	H mm inch	Z	RPM max.	Pack.	1		5	
						STH 0.35 0.014" Art.-No.	STH 0.50 0.020" Art.-No.	STM 0.35 0.014" Art.-No.	STM 0.50 0.020" Art.-No.
65 2 1/2	M 10 x 1.5	20 3/4	18	12,500	1	482.114*	482.214*	available on demand	
65 2 1/2	M 14 x 2.0	20 3/4	18	12,500	1	482.117*	482.217*	482.317*	482.117.SM* 482.217.SM*
75 3	M 14 x 2.0	20 3/4	20	12,500	1	483.117*	483.217*	483.317	
90 3 1/2	M 14 x 2.0	22 7/8	20	11,500	1	485.137*	485.237*	485.337	485.237.SM*
100 4	M 14 x 2.0	25 1	26	9,000	1	available on demand	486.237*	available on demand	
125 5	M 14 x 2.0	25 1	32	7,000	1	available on demand	487.237	available on demand	
150 6	M 14 x 2.0	30 1 1/4	36	6,600	1	available on demand	488.237	available on demand	
150 6	W5/8x11NC	30 1 1/4	36	6,600	1	available on demand	488.238	available on demand	
2	65 2 1/2	M 14 x 2.0	20 3/4	18	12,500	1	available on demand	482.217.WZ*	

3 Knot Cup Brushes, without Bridle, 1 Row, Steel Wire, with extra long filling

D mm inch	d mm inch	H mm inch	Z	RPM max.	Pack.	STH 0.35 0.014" Art.-No.	STH 0.50 0.020" Art.-No.
80 3 1/4	M 14 x 2.0	33 1 1/4	18	12,500	25	480.117	480.217

4 Knot Cup Brushes without Bridle, 2 Rows, Steel Wire

D mm inch	d mm inch	H mm inch	Z	RPM max.	Pack.	STH 0.35 0.014" Art.-No.	STH 0.50 0.020" Art.-No.	STH 0.80 0.031" Art.-No.
100 4	W 5/8 x 11 NC	25 1	26+20	9,000	1	486.148	486.248	486.348
125 5	W 5/8 x 11 NC	25 1	32+26	7,000	1	available on demand	487.248	available on demand
150 6	W 5/8 x 11 NC	25 1	36+32	6,600	1	available on demand	488.248	available on demand

* Packed 10 pieces per carton

Cup Brushes

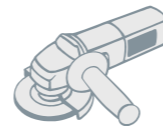

IIIIII
EAN

Knot Cup Brushes with Bridle, 1 Row, Steel Wire

D	d	H	Z	RPM	Pack.	STH 0.35 0.014"	STH 0.50 0.020"	STH 0.80 0.031"
mm inch	mm inch	mm inch		max.		Art.-No.	Art.-No.	Art.-No.
80 3 1/4	22.2 7/8	25 1	20	9,000	1	484.111	484.211*	484.311*
80 3 1/4	M 14 x 2.0	25 1	20	9,000	1	484.117*	484.217*	484.317*
80 3 1/4	W 5/8 x 11 NC	25 1	20	9,000	1	484.118	484.218	484.318
100 4	22.2 7/8	23 7/8	26	9,000	1	486.111	486.211*	486.311*
100 4	M 14 x 2.0	23 7/8	26	9,000	1	486.117*	486.217*	486.317*
100 4	W 5/8 x 11 NC	23 7/8	26	9,000	1	486.118	486.218*	486.318*
125 5	22.2 7/8	25 1	32	7,000	1	487.111	487.211	487.311
125 5	M 14 x 2.0	25 1	32	7,000	1	487.117	487.217	487.317
125 5	W 5/8 x 11 NC	25 1	32	7,000	1	487.118	487.218	487.318

* Packed 10 pieces per carton

After removing the bridle there are the following further trimming lengths :

Ø 80 und 125: 15 mm / 5/8 inch
Ø 100: 12.5 mm / 1/2 inch

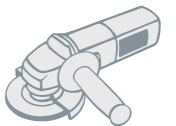

IIIIII
EAN

Knot Cup Brushes without Bridle, 1 Row, Stainless Steel Wire

D	d	H	Z	RPM	Pack.	ROH 0.35 0.014"	ROH 0.50 0.020"
mm inch	mm inch	mm inch		max.		Art.-No.	Art.-No.
65 2 1/2	M 10 x 1.5	20 3/4	18	12,500	1	482.714	482.814*
65 2 1/2	M 14 x 2.0	20 3/4	18	12,500	1	482.717*	482.817*
75 3	M 14 x 2.0	20 3/4	20	12,500	1	available on demand	483.817*
80 3 1/4	M 14 x 2.0	33 1 1/4	18	15,500	25	480.717	available on demand
65 2 1/2	M 14 x 2.0	20 3/4	18	12,500	1	available on demand	482.817.WZ*

IIIIII
EAN

Knot Cup Brushes with Bridle, 1 Row, Stainless Steel Wire

D	d	H	Z	RPM	Pack.	ROH 0.35 0.014"	ROH 0.50 0.020"
mm inch	mm inch	mm inch		max.		Art.-No.	Art.-No.
80 3 1/4	22.2 7/8	25 1	20	9,000	1	484.711	484.811
80 3 1/4	M 14 x 2.0	25 1	20	9,000	1	484.717	484.817*
80 3 1/4	W 5/8 x 11 NC	25 1	20	9,000	1	484.718	484.818
100 4	22.2 7/8	23 7/8	26	9,000	1	486.711	486.811
100 4	M 14 x 2.0	23 7/8	26	9,000	1	486.717*	486.817*
100 4	W 5/8 x 11 NC	23 7/8	26	9,000	1	486.718	486.818
125 5	M 14 x 2.0	23 7/8	32	9,000	1	available on demand	487.817

* Packed 10 pieces per carton

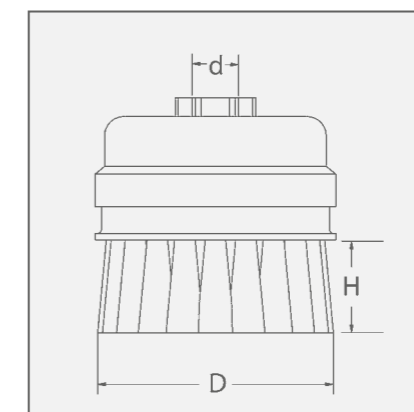

Item Nos. in bold are available ex stock. Consider our minimum order value for *italic printed* article numbers (see page 139).

STH = steel wire, high tensile, straight
ROH = stainless steel wire, high tensile, straight

Cup Brushes



Cup Brushes with Crimped Wire

D	d	H	RPM	Pack.	1					
					STA 0.20 0.008"	STA 0.35 0.014"	STA 0.50 0.020"	ROH 0.30/0.35 0.012"	MES 0.30 0.012"	
mm inch	mm inch	max.		Art.-No.	Art.-No.	Art.-No.	Art.-No.	Art.-No.		
60	2 3/8	M 10 x 1,5	20	12,000	1	421.164*		421.364	421.564	
60	2 3/8	M 14 x 2.0	20	12,000	1	421.147	421.167*	421.197	421.367*	421.567*
75	3	M 14 x 2.0	25	12,500	1		423.167*	available on demand	423.367*	available on demand
75	3	W 5/8 x 11 NC	25	12,500	1		423.168*	available on demand	423.368	available on demand
80	3 1/4	22.2 7/8	25	8,500	1		424.171*	available on demand	424.361	available on demand
80	3 1/4	M 14 x 2.0	25	8,500	1	424.147	424.177*	424.197	424.367*	424.567
80	3 1/4	W 5/8 x 11 NC	25	8,500	1		424.178	424.198	424.368	available on demand
100	4	22.2 7/8	30	9,000	1		426.171*	426.191	426.361	426.561
100	4	M 14 x 2.0	30	9,000	1	426.147*	426.177*	426.197*	426.367*	426.567
100	4	W 5/8 x 11 NC	30	9,000	1		426.178*	426.198	426.368	426.568
125	5	22.2 7/8	30	8,000	1		427.171	available on demand	available on demand	available on demand
125	5	M 14 x 2.0	30	8,000	1	427.147	427.177	427.297	427.367*	427.567*
125	5	W 5/8 x 11 NC	30	8,000	1		427.178	427.298		
150	6	22.2 7/8	40	6,500	1		429.171	429.191		
150	6	M 14 x 2.0	40	6,500	1		429.177	429.197	429.367	
150	6	W 5/8 x 11 NC	40	6,500	1		429.178	429.198		

Cup Brushes, Brass Coated Steel Wire, Abrasive Filament

D	d	H	RPM	Pack.	4				
					STL 0.35 0.014"	STM 0.30 0.012"	SIC 80/1.2	SIC 180/0.9	
mm inch		max.			Art.-No.	Art.-No.	Art.-No.	Art.-No.	
65	2 3/8	M 14 x 2.0	20	12,000	1		421.767	421.827	421.857
100	4	22.2 7/8	30	9,000	1	426.701			
100	4	M 14 x 2.0	30	9,000	1	426.707	426.767		

* Packed 10 pieces per carton

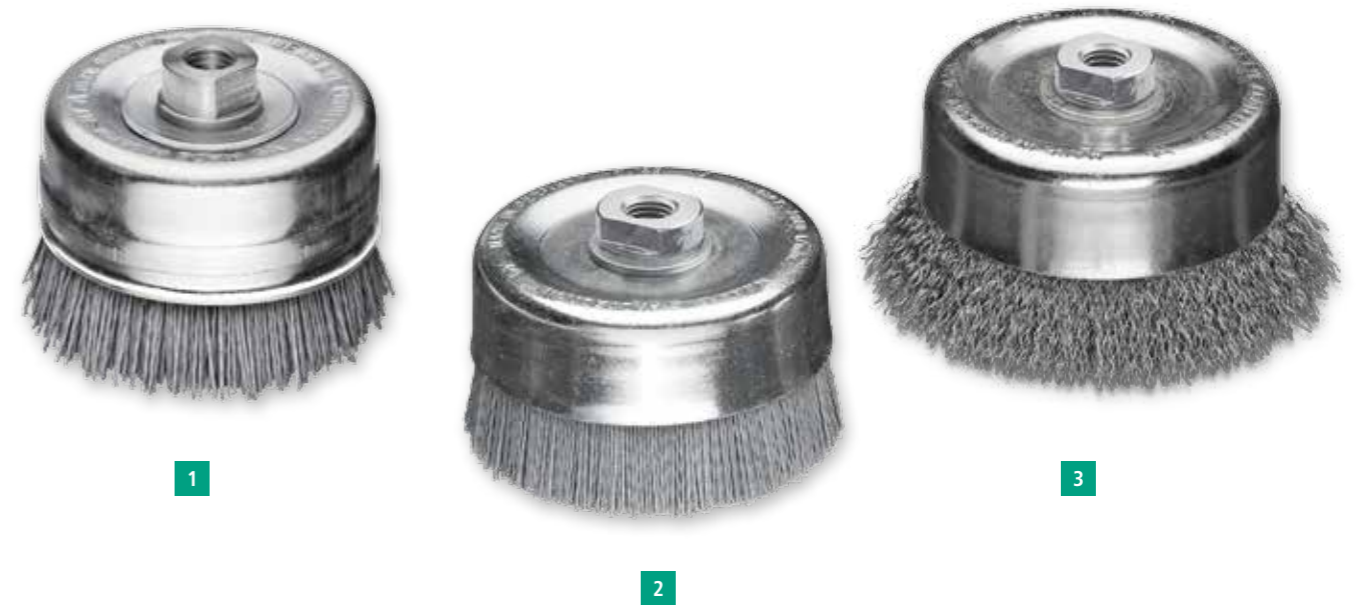

Cup Brushes, Straight Filament

D	d	H	RPM	Pack.	STH 0.35 0.014"	STM 0.35 0.014"	STL 0.35	SIC 80/1.2	SIC K180/1.0
					Art.-No.	Art.-No.	Art.-No.	Art.-No.	Art.-No.
mm inch	mm inch	max.							
90	3 1/2	M 14	25	9,000	1			446.827*	446.857*
90	3 1/2	22.2 7/8	25	9,000	1			available on demand	446.851*
100	4	M 14	30	9,000	1	446.277*	446.777*		
100	4	22.2 7/8	30	9,000	1	446.271*	446.771*	446.701*	
110	4 1/2	M 14	30	7,000	1			447.827*	447.857*
125	5	M 14	30	7,000	1	447.277*	available on demand	available on demand	

1 with bridle | * Packed 10 pieces per carton

Cup Brushes with Straight Wire
They are used for deburring surfaces, mostly in machining centers. The brushes are available with steel wire, stainless steel wire, abrasive nylon or any other filament. Due to the straight cup the filament of the brush is less flaring out and more cone points of the bristles work on the surface. Please contact us for more information!

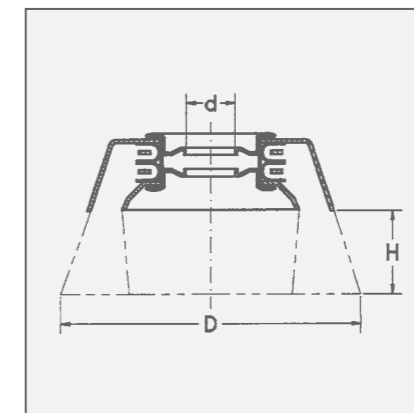

Item Nos. in bold are available ex stock. Consider our minimum order value for italic printed article numbers (see page 139).

- STA = steel wire, crimped
- STH = steel wire, high tensile, straight
- STM = brass coated steel, crimped
- STL = cord wire, crimped
- ROH = stainless steel wire, high tensile, straight
- MES = brass wire, crimped
- SIC = silicon carbide bristles

Bevel Brushes



Bevel Brushes

The special shape of these brushes enables the user to work in hard to reach places. The knots are left hand twisted to increase stability. For promoting sales all standard knot bevel brushes are packed individually for self display. These brushes are also available bulk packed.

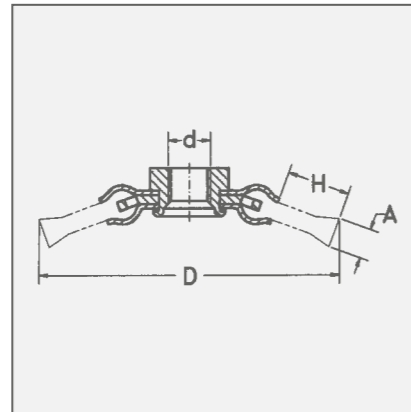

Item Nos. in bold are available ex stock. Consider our minimum order value for *italic printed* article numbers (see page 139).

STA = steel wire, crimped

STM = brass coated steel wire

STH = steel wire, high tensile, straight

ROF = stainless steel wire, crimped

ROH = stainless steel wire, high tensile, straight

Wheel Brushes with thread

Like bevel brushes, wheel brushes with a thread are ideal for working in areas which are hard to reach. Usually the brushes are used on angle grinders.

Other measurements and filling materials are available on request.

Stainless Steel Brushes

LESSMANN brushes with stainless steel wire have green cups. We use wire with material number 1.4310. Material number 1.4401 can be used on request.

More information for brush applications on stainless materials you will find at www.lessmann.com

Bevel Brushes, left-right knotted

Left-right knotted bevel brushes usually are more aggressive, hence they are often used for heavy brushing operations.

Besides the knots open less, therefore there are ideal for the treatment of edges.



III III III III EAN Knot Bevel Brushes, Steel Wire, Stainless Steel Wire

D mm inch	A mm inch	d mm inch	H	Z	RPM max.	Pack.	1		2	
							STH 0.35 0.014"	STH 0.50 0.020"	ROH 0.35 0.014"	ROH 0.50 0.020"
							Art.-No.	Art.-No.	Art.-No.	Art.-No.
100 4	12 1/2	M 10 x 1.5	20	18	12,500	1		471.254		
100 4	12 1/2	M 14 x 2.0	20	18	12,500	1	471.157*	471.257*	471.757*	471.857*
100 4	12 1/2	22.2 7/8	20	18	12,500	1		471.251		
115 4 1/2	12 1/2	M 14 x 2.0	24	20	15,000	1	472.157*	472.257*	472.757*	472.857*
115 4 1/2	12 1/2	22.2 7/8	24	20	15,000	1		472.251		
115 4 1/2	12 1/2	M 14 x 2.0	24	24	15,000	1		472.257.V4*		
125 5	12 1/2	M 14 x 2.0	29	20	15,000	1		473.257*		
3	115 4 1/2	12 1/2	M 14 x 2.0	24	20	15,000	1		472.257.WZ*	472.857.WZ*

III III III III EAN 4 Knot Bevel Brushes, Steel Wire, Brass coated steel wire

D mm inch	A mm inch	d mm inch	H	Z	RPM max.	Pack.		
							STM 0.35 0.014"	STM 0.50 0.020"
							Art.-No.	Art.-No.
100 4	12 1/2	M 14 x 2.0	20	18	12,500	1	471.157.SM*	
115 4 1/2	12 1/2	M 14 x 2.0	24	20	15,000	1		472.257.SM*

III III III III EAN Bevel Brushes, Crimped Wire

D mm inch	A mm inch	d	H	RPM max.	Pack.	5		6	
						STA 0.35 0.014"	ROF 0.30 0.012"	STM 0.30 0.012"	
							Art.-No.	Art.-No.	Art.-No.
100 4	10 3/8	M 14 x 2.0	20	15,000	1	422.177*	422.367*	422.767	

III III III III EAN 7 Wheel Brushes, crimped wire, with thread

D mm inch	A mm inch	d	H	RPM max.	Pack.		
						ROF 0.30 0.012"	STM 0.30 0.012"
						Art.-No.	Art.-No.
115 4 1/2	12 1/2	M 14	24	12,500	1	304.361.14	304.761.14
125 5	13 1/2	M 14	19.5	12,500	1	335.361.14	335.761.14

* Packed 10 pieces per carton

Brushes for grass trimmers



Brushes for grass trimmers

Knotted brushes on grass trimmers are ideal for removing weeds on grass pavers, curbstones, cobbled areas or other spots which are hard to reach. Those brushes clean larger areas like courtyards, terraces or longer alleys effortlessly and sustainably.

Besides, brushes are ecologically friendly and they remove weeds fast and effectively.

Attention: When working with brushes on grass trimmers, please be aware of stringent safety rules. Please take note of the data sheet we attach the brushes or have a look at www.lessmann.com.



Right adaption of the brush

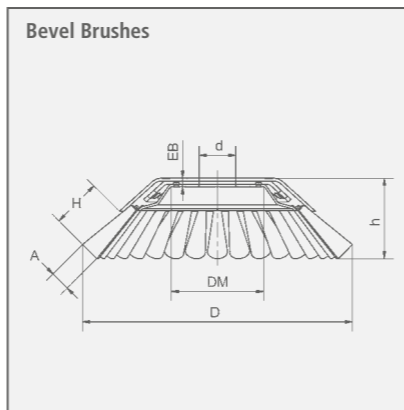
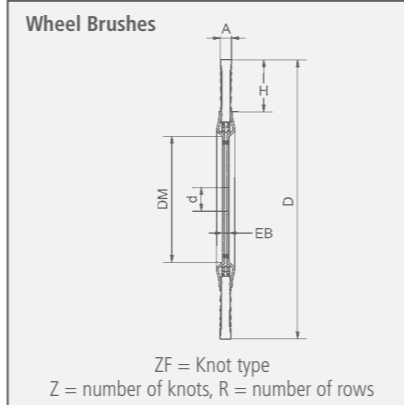

Item Nos. in bold are available ex stock. Consider our minimum order value for *italic printed* article numbers (see page 139).

STM = brass coated steel, straight

STH = steel wire, high tensile, straight



	Knotted Wheel Brushes, for grass trimmers											STH 0.50 0.020"	
	D	A	EB	DM	H	Z	d	ZF	RPM	Pack.		Art.-No.	
	mm inch	mm inch			mm inch		mm inch		max.				
1	175 6 ^{7/8}	6 1/4	8	68	34 1 ^{1/4}	40	20 3/4	B	12,500	1		475.260.01	
	175 6 ^{7/8}	6 1/4	6	68	34 1 ^{1/4}	40	25.4 1	B	12,500	1		475.261.01	
	200 8	6 1/4	8	68	46 1 ^{49/64}	40	20 3/4	B	12,500	1		476.260.01	
2	200 8	6 1/4	6	68	46 1 ^{49/64}	40	25.4 1	B	12,500	1		476.261.01	
	250 10	6 1/4	3	83	42 1 ^{5/8}	56	20 3/4	B	10,000	1		477.260.01	
	250 10	6 1/4	3	83	42 1 ^{5/8}	56	25.4 1	B	10,000	1		477.261.01	
	300 12	6 1/4	3	83	67 2 ^{5/8}	56	20 3/4	B	10,000	1		478.260.01	

	Knotted Bevel Brushes, for grass trimmers												
	D	A	EB	DM	H	h	Z	d	ZF	RPM	Pack.	STH 0.50 0.020"	STM 0.50 0.020"
	mm inch	mm inch			mm inch			mm inch		max.		Art.-No.	Art.-No.
3	170 6 ^{3/4}	12 1/2	6	50	50 2	58	32	20 3/4	B	10,000	1	475.250.01	
	170 6 ^{3/4}	12 1/2	6	50	50 2	58	32	25.4 1	B	10,000	1	475.251.01	
4	200 8	14 9/16	6	64	37 1 ^{1/2}	55	36	20 3/4	B	10,000	1	476.250.01	476.250.SM
	200 8	14 9/16	6	64	37 1 ^{1/2}	55	36	25.4 1	B	10,000	1	476.251.01	476.251.SM

The brushes are suitable for all common grass trimmer and brush cutter models. Possible special diameters or special bores are deliverable on demand.